



iClock880-H

Large Capacity Fingerprint Time Attendance and Access Control

iClock880-H time attendance and access control terminal adopts ZKSoftware latest ZEM600 platform with ZKFinger 10.0 algorithm to improve identification speed. The device can store 50000 fingerprint templates. iClock880-H features ZK's high performance, high image quality optical fingerprint sensor. The patented optical sensor is resistant to scratches and impact. the device has camera and 3.5"

color TFT-LCD display. The communication interface of the device includes TCP/IP, RS232/485 and USB-Host. Backup battery is standard in case of power failure. The device has professional access control function it can be used in multi-factor identification modes including fingerprint, password, RFID card or any combination.

Features

- 50,000 templates (1: N) and 800,000 records.
- Multimedia 3.5" TFT screen.
- Internal Camera and Photo-ID support the user's photo display and make T&A application more visible and reliable.
- Built-in backup battery.
- Optional integrated proximity or smart card reader.
- Built-in USB port allows for manual data transfer when network isn't available.
- 8 user-defined function keys.
- Relay contacts for lock and alarm.
- Multi Language Support.
- Audio-Visual indications for acceptance and rejection of valid/invalid fingers.
- SDK available for OEM customers and software devel opers.

Specifications

Fingerprint Capacity	50,000 templates
Transaction Capacity	800,000 Events
Hardware Platform	ZEM600
Sensor	ZK Optical Sensor
Algorithm Version	ZK Finger v10.0
Communication	RS232/485, TCP/IP, USB-host
Standard Functions	Workcode, SMS, DST, Scheduled-bell, Self-Service Query, Automatic Status Switch, T9 input, battery, Anti-passback, 9 digit user IDphoto-ID, Camera, built-in
Access Control Interface for	battery, Anti-passback, 9 digit user ID Bell, Anti-pass back
Wiegand Signal	Input & Output
Optional Functions	ID/Mifare/HID, printer, soap, 14 digit user ID
Display	3.5 inches TFT Screen
Power Supply	12V DC 3A
Operating Temperature	0°C - 45°C
Operating Humidity	20% - 80%
Dimension	213×178.2×47.5 mm
Gross Weight	2.00 kg

Configuration

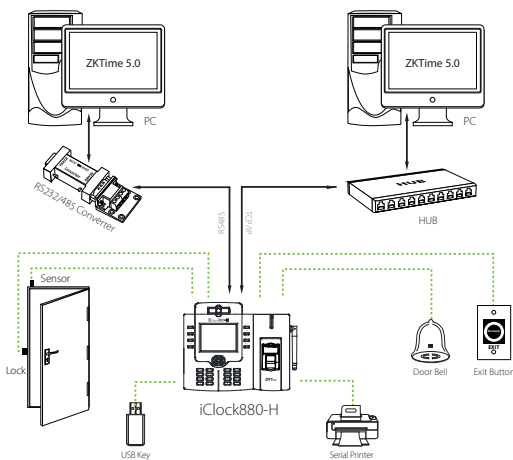

What's in the Box

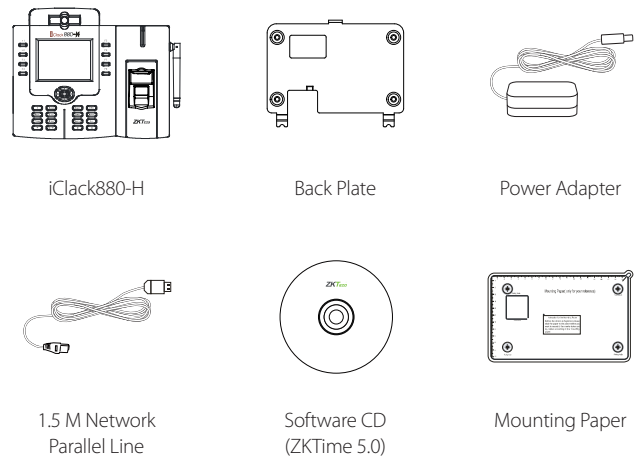

ZKTeco Inc.
 ZK Mansion, Wuhe Rd, Gangtuo, Bantian, Buji Town,
 Longgang District, Shenzhen China 518129
 Tel: 86-755-8960 2345/46/47/48
 E-mail: sales@zkteco.com
 www.zkteco.com

Global Offices:
 USA: +1 732-412-6007
 EU: +34 916532891
 Brazil: +55 31 2515-8326
 Thailand: +66-027199154
 Mexico: +52-55-52928418

South Africa: +27 12 259 1047
 Egypt: +201110444134
 Dubai: +971 4 6091 310
 India: +91 8123536788
 Indonesia: +62 21 2921 8949

Vietnam : +84-0169-5813007
 Philippines: +63 9084118832
 Russia: +8 915 178-46-81